



## AHL series Wide Type Air Gripper



### Feature

- Parallel shift clamp
- Built-in magnet
- Multiple ways to install

### Specification

Item	Bore size(mm)	Ø10	Ø16	Ø20	Ø25	Ø32	Ø40
Action		Double acting					
Fluid		Air					
Pressure range	kgf / cm <sup>2</sup> (kPa)	1.5 ~ 7(150 ~ 700)					
Ambient and fluid temperature	°C	0 ~ 60					
Max. operation frequency	time/min	40	40	40	40	20	20
Lubrication		Lubrication free type					
Theoretical holding force	N	14	44	73	128	228	396
Max. gripper point length (L)	mm	40	60	80	90	100	100
Opening/ closing stroke	mm	20, 40, 60	30, 60, 80	40, 80, 100	50, 100, 120	70, 120, 160	100, 160, 200
Port size	mm	M5X0.8P				PT1/8	
Sensing device		With magnet					

Note: L: The gripping point length is 40mm applicable to Ø16, Ø20, Ø25, the gripping point length is 80mm applicable to Ø32, Ø40  
P: Operating pressure=5 kgf/cm<sup>2</sup>

### Product weight

Model	AHL 1020	AHL 1040	AHL 1060	AHL 1630	AHL 1660	AHL 1680	AHL 2040	AHL 2080	AHL 20100
Weight(kg)	0.29	0.35	0.44	0.57	0.79	0.94	1.0	1.45	1.7
Model	AHL 2550	AHL 25100	AHL 25120	AHL 3270	AHL 32120	AHL 32160	AHL 40100	AHL 40160	AHL 40200
Weight(kg)	1.7	2.6	2.8	3	4.03	5.01	5.3	6.9	8

Note: All of above are theoretical data. Weight tolerance about±5%



## Code of order

AHL-1020-B-AMS-L-2  
① ② ③ ④ ⑤

①

Mark	Bore size(mm)
10	Ø10
16	Ø16
20	Ø20
25	Ø25
32	Ø32
40	Ø40

②

Bore size (mm)	Stroke (mm)
Ø10	20, 40, 60
Ø16	30, 60, 80
Ø20	40, 80, 100
Ø25	50, 100, 120
Ø32	70, 120, 160
Ø40	100, 160, 200

③

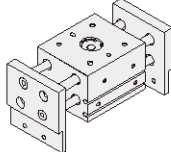
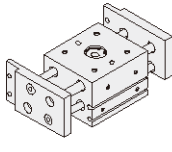
Mark	Fingertype	Mark	Finger type
None: Standard		B: Finger side gripper	

④

AMS-□

↓

Model :

- M-2 wire Without contact
- N-3 wire Without contact(NPN)
- P-3 wire Without contact(PNP)

wire length-L : 2000mm

L-straight cable 

V-angle cable(90°) 

⑤

Mark	Sensor quantity
1	With 1 sensor switch
2	With 2 sensor switches



## Characteristics graph

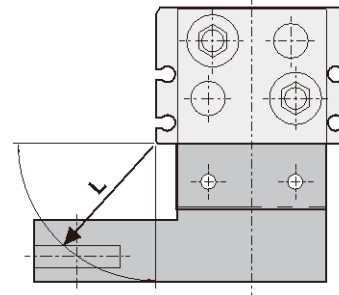
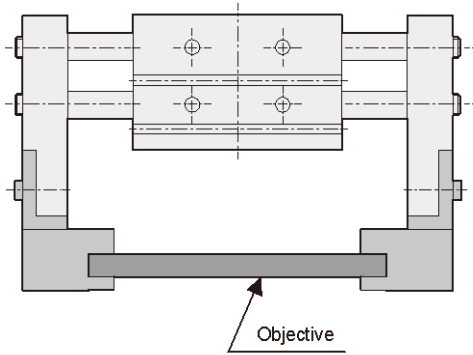

L : Gripping position (mm)

**AHL 1020**

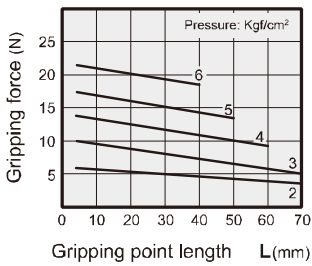

**AHL 1040 AHL 1060**

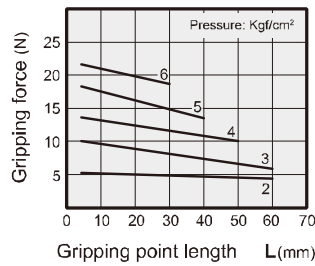

**AHL 1630**

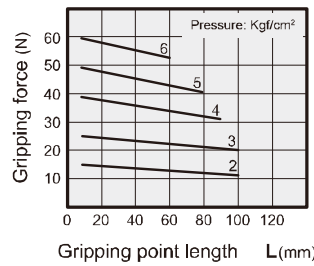

**AHL 1660 AHL 1680**

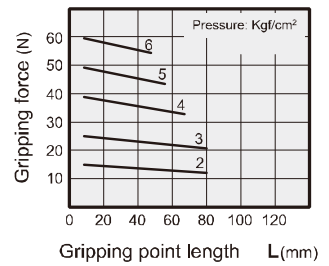

**AHL 2040**

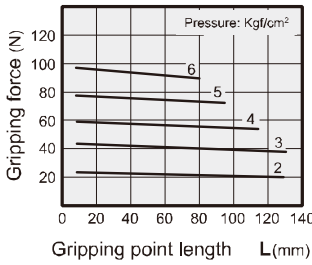

**AHL 2080 AHL 20100**

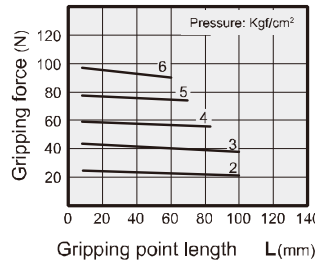

**AHL 2550**

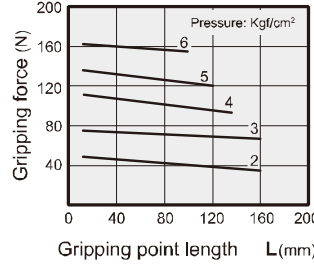

**AHL 25100 AHL 25120**

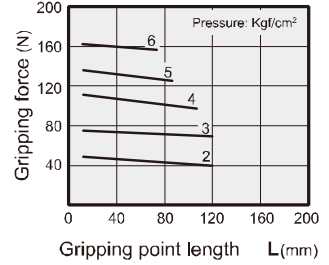

**AHL 3270**

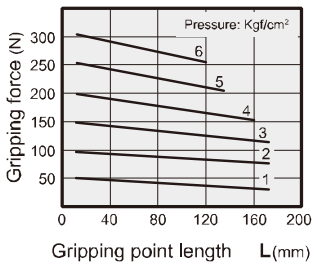

**AHL 32120 AHL 32160**

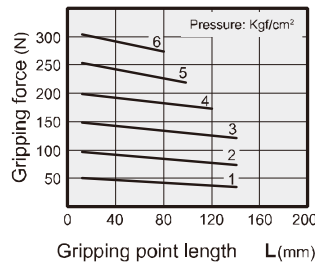

**AHL 40100**

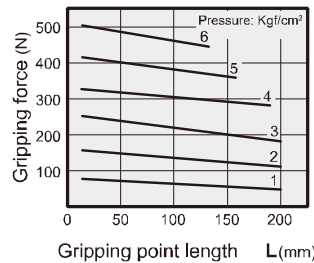

**AHL 40160 AHL 40200**

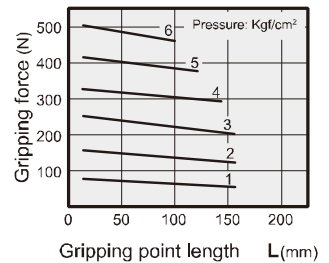

## Dimensions

### AHL-10

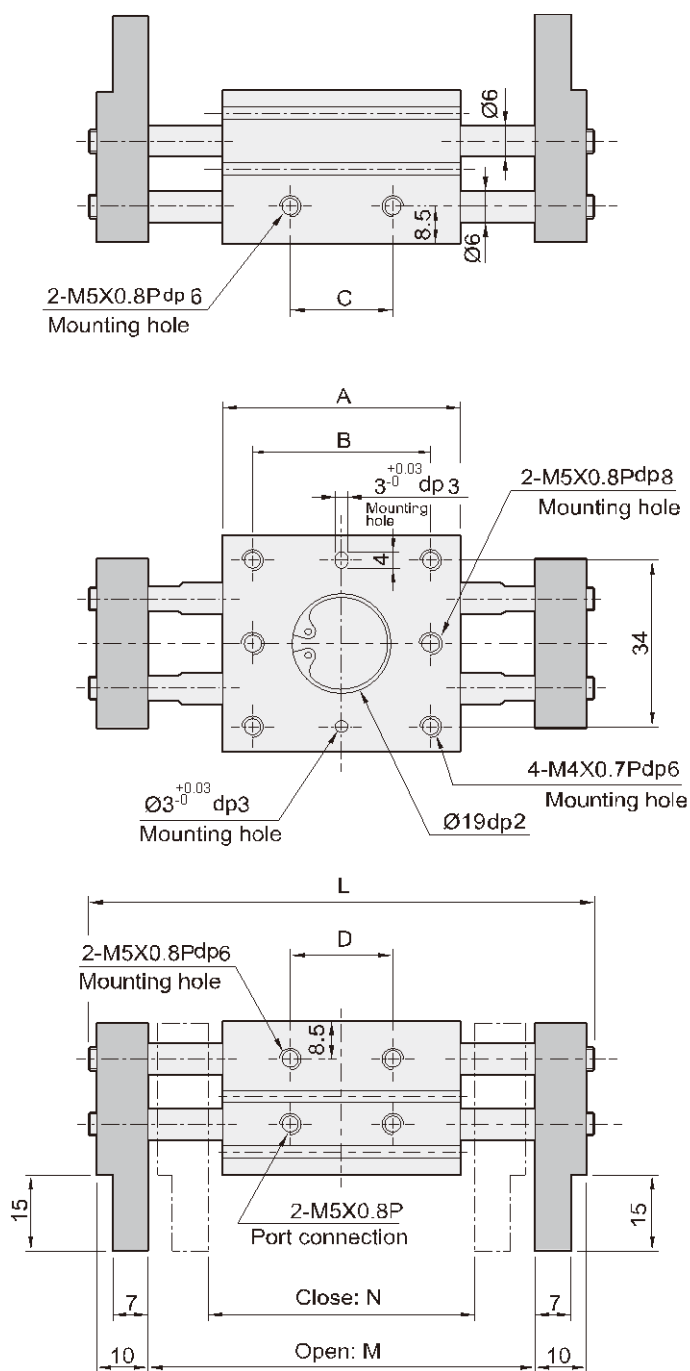

### (Finger side gripper)

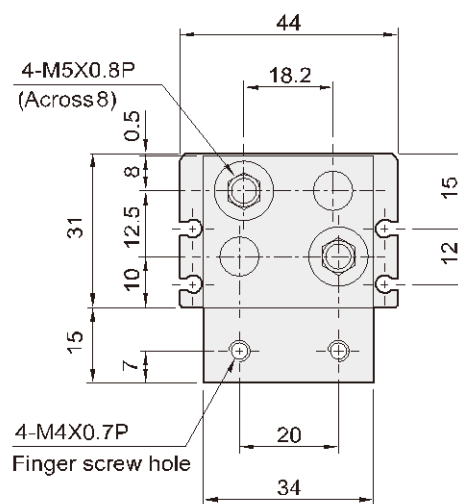
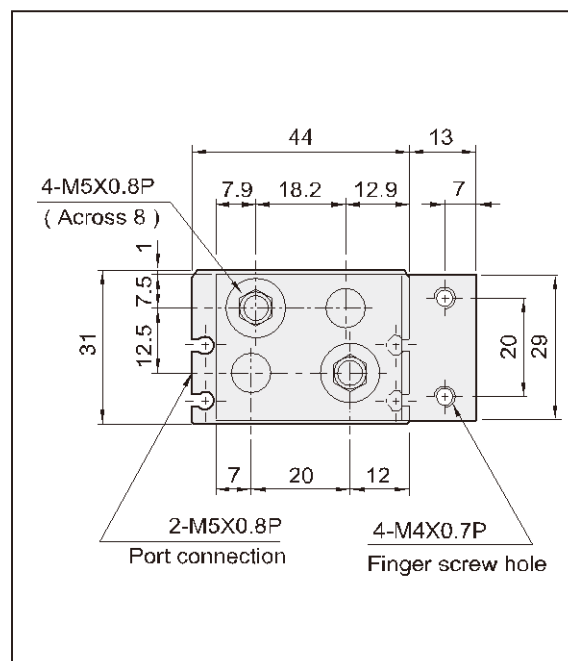

Unit: mm

Model	A	B	C	D	L	M	N
AHL 1020	52	36	30	30	100(80)	76	56
AHL 1040	68	52	46	46	136(96)	112	72
AHL 1060	86	70	64	64	174(114)	150	90

## AHL-16

(Finger side gripper)

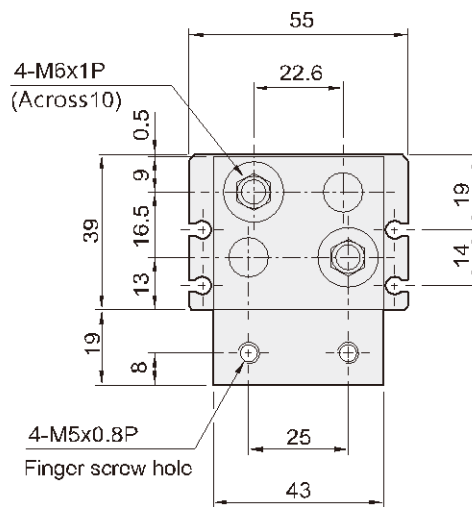
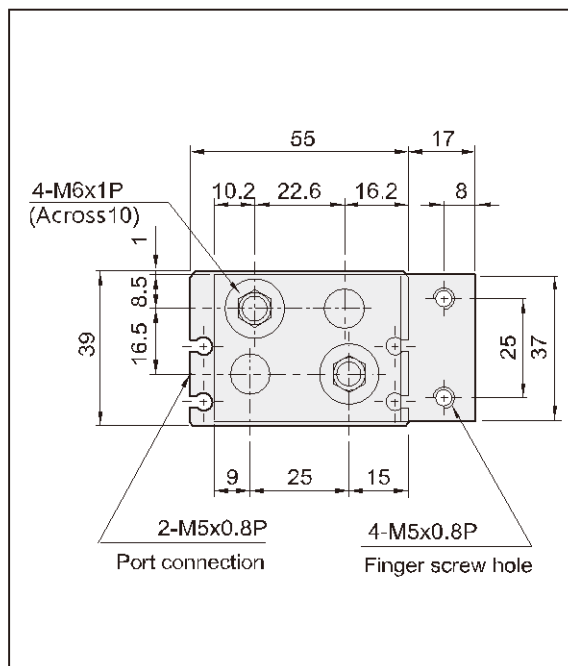
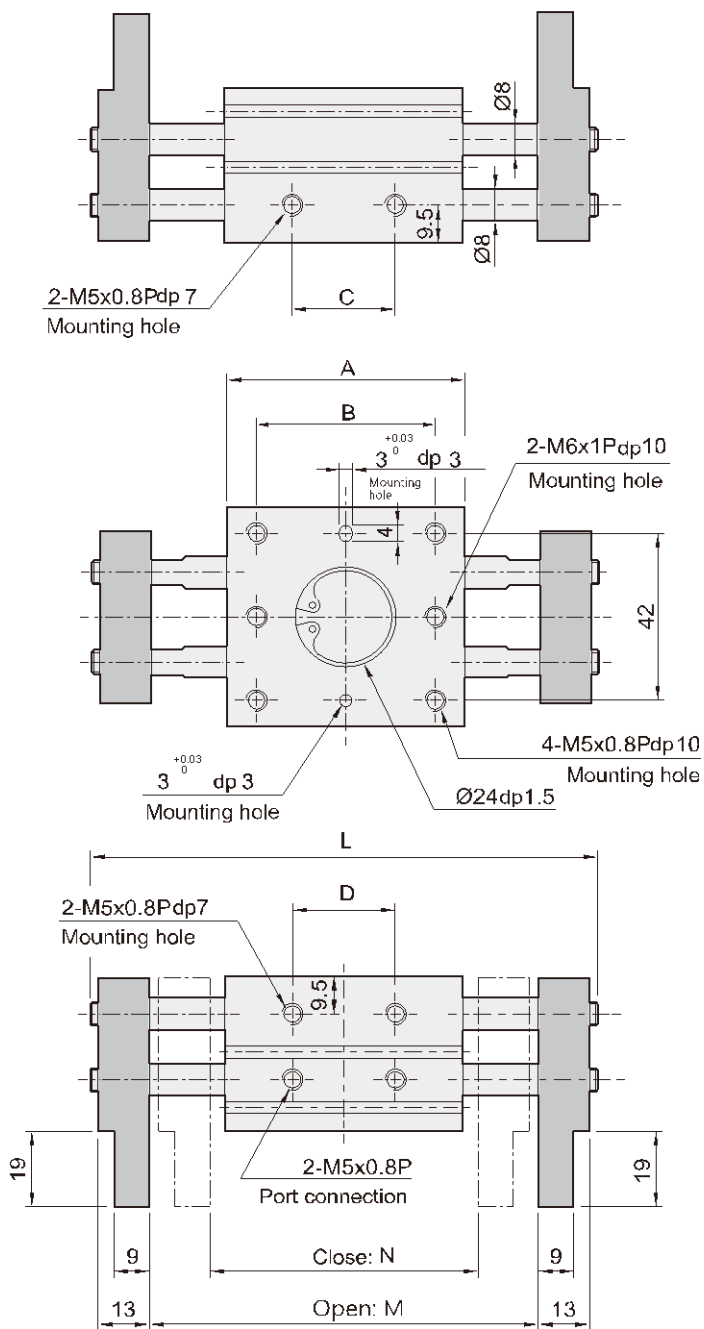

Unit: mm

Model	A	B	C	D	L	M	N
AHL 1630	60	45	26	26	128(98)	98	68
AHL 1660	90	75	56	56	188(128)	158	98
AHL 1680	110	95	76	76	228(148)	198	118

## AHL-20

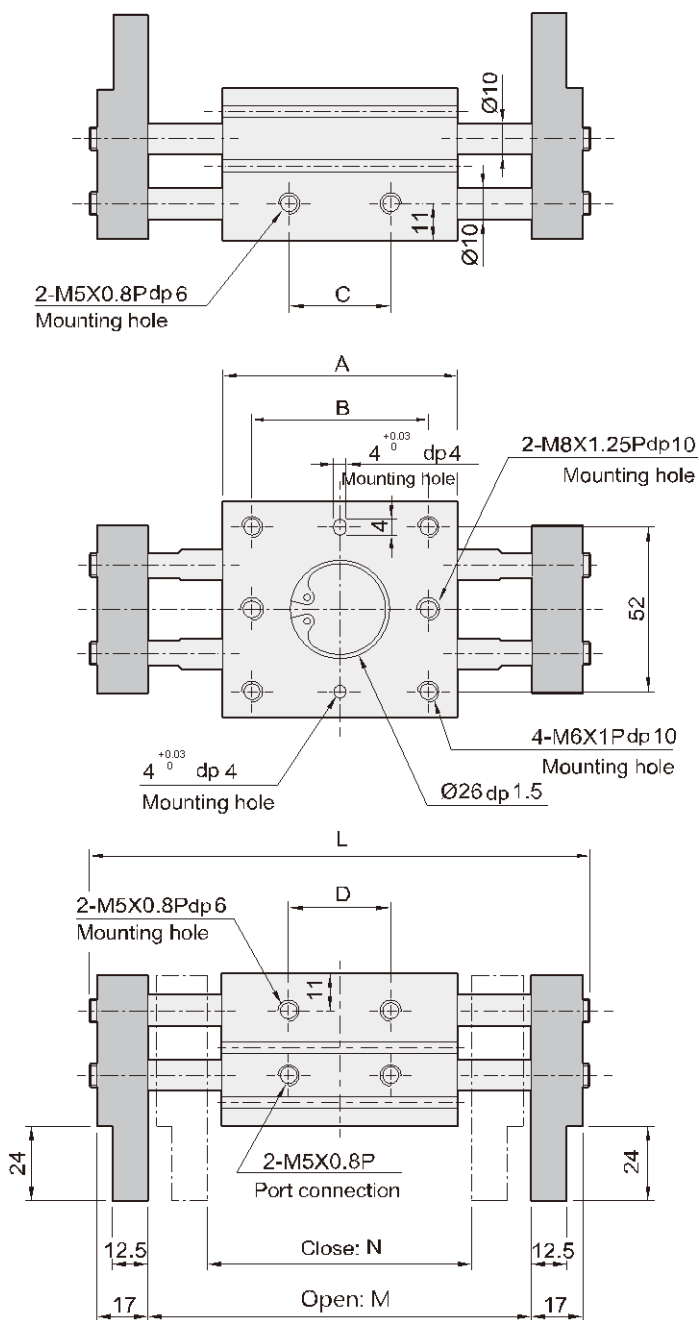

## (Finger side gripper)

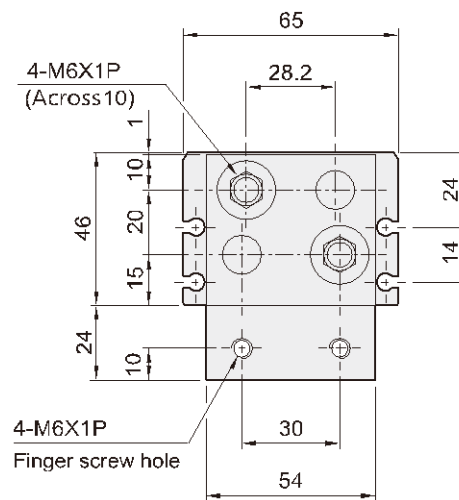
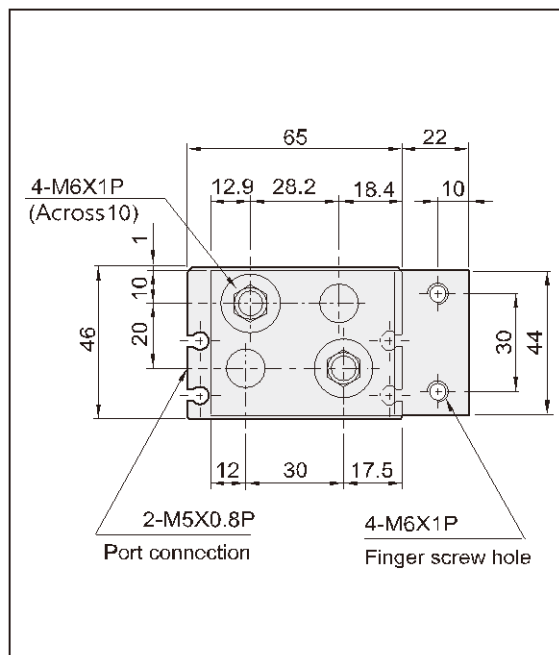

Unit: mm

Model	A	B	C	D	L	M	N
AHL 2040	71	58	40	40	157(117)	119	79
AHL 2080	113	100	82	82	239(159)	201	121
AHL 20100	133	120	102	102	279(179)	241	141

## AHL-25

(Finger side gripper)

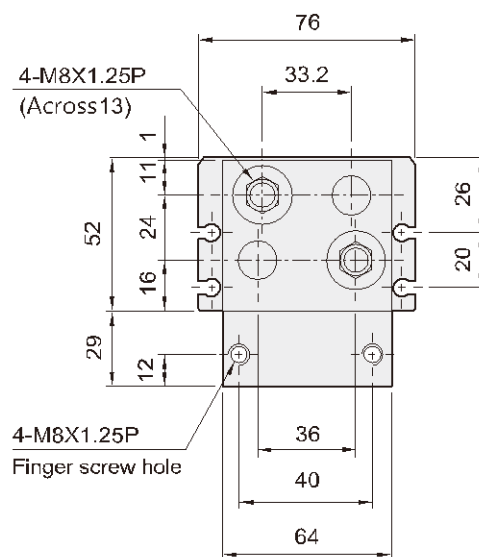
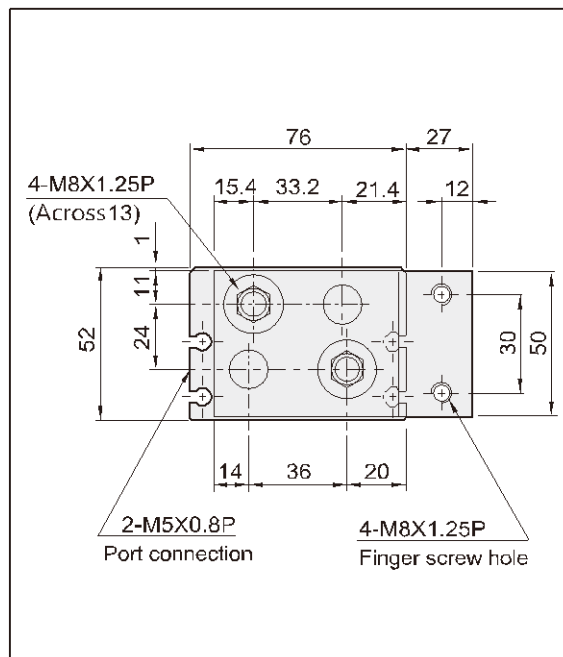
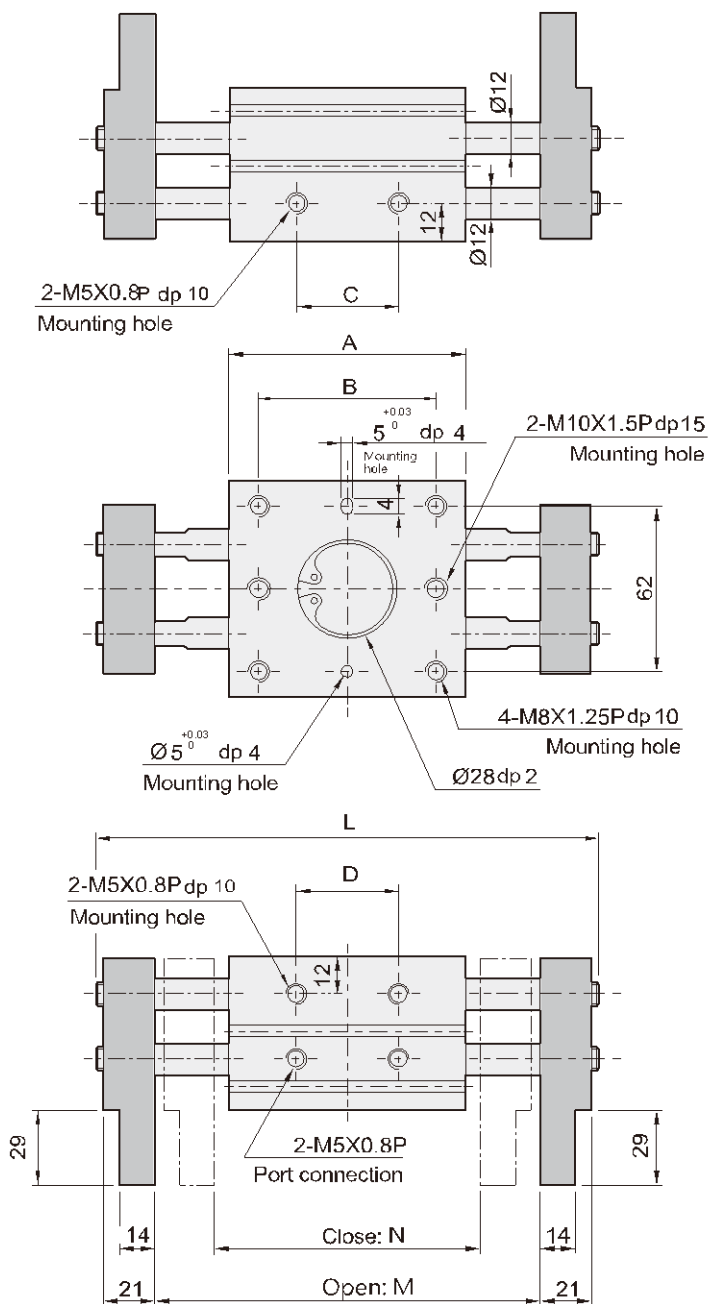

Unit: mm

Model	A	B	C	D	L	M	N
AHL 2550	88	70	50	50	192(142)	146	96
AHL 25100	142	124	104	104	296(196)	250	150
AHL 25120	160	142	122	122	334(214)	288	168

## ■ AHL-32

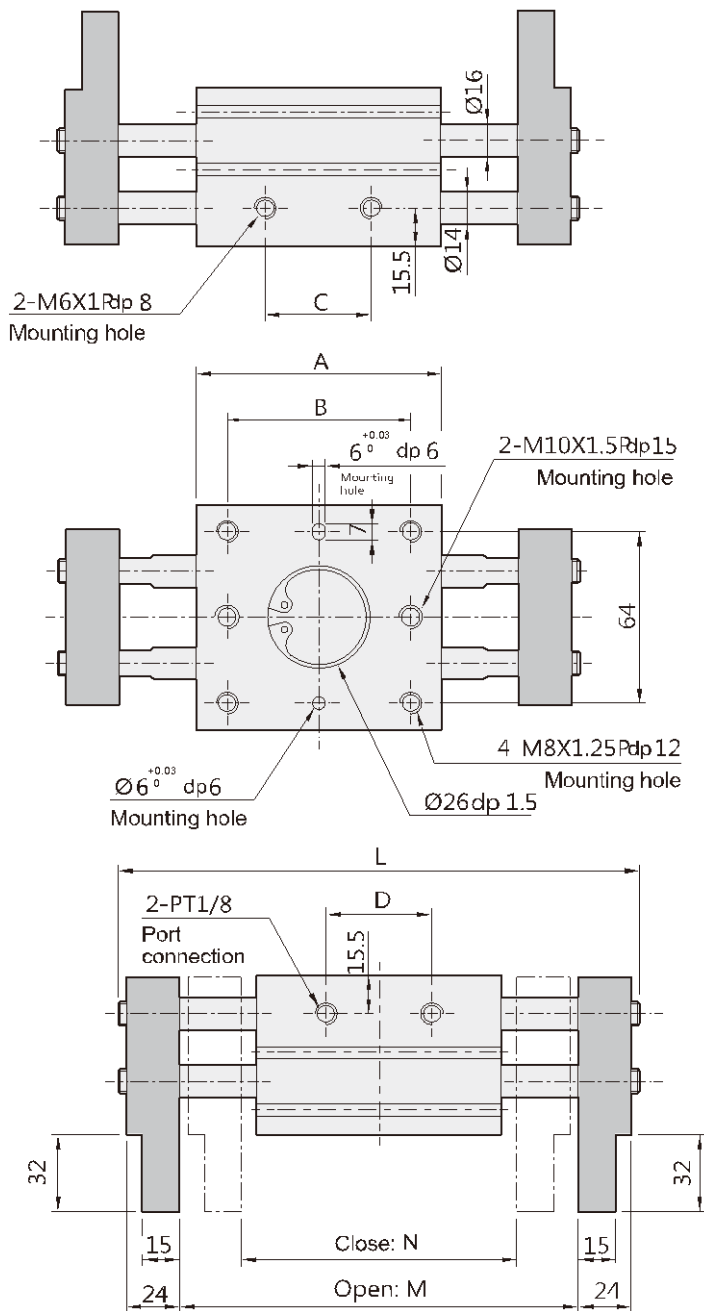

## ■ (Finger side gripper)

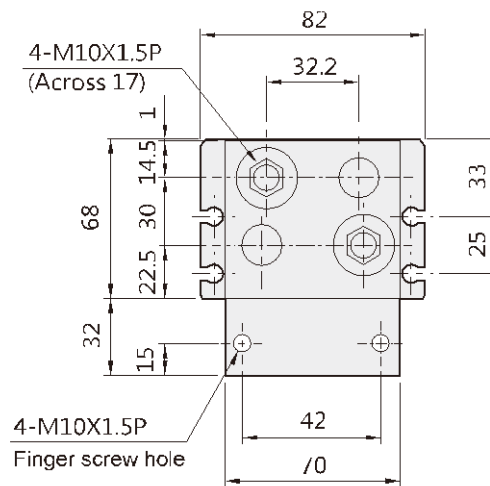
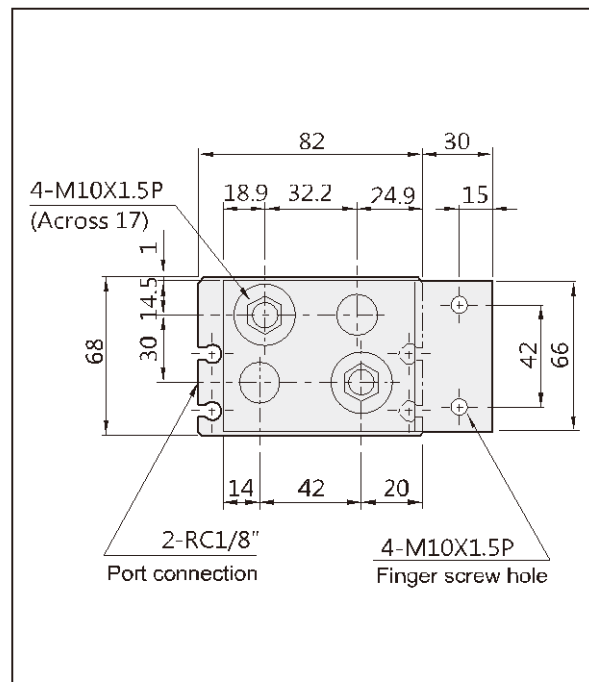

Unit: mm

Model	A	B	C	D	L	M	N
AHL 3270	110	86	69	69	240(170)	188	118
AHL 32120	158	134	117	117	338(218)	286	166
AHL 32160	202	178	161	161	422(262)	370	210





## ■ AHL-40

■ (Finger side gripper)

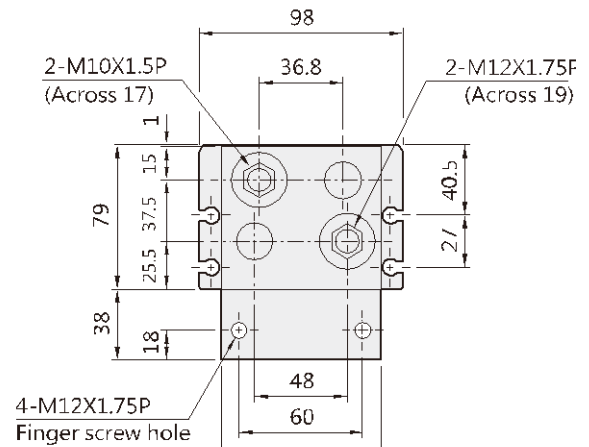
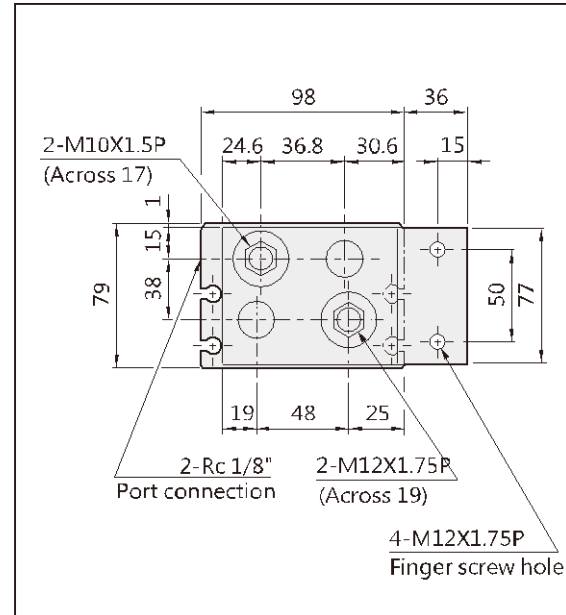
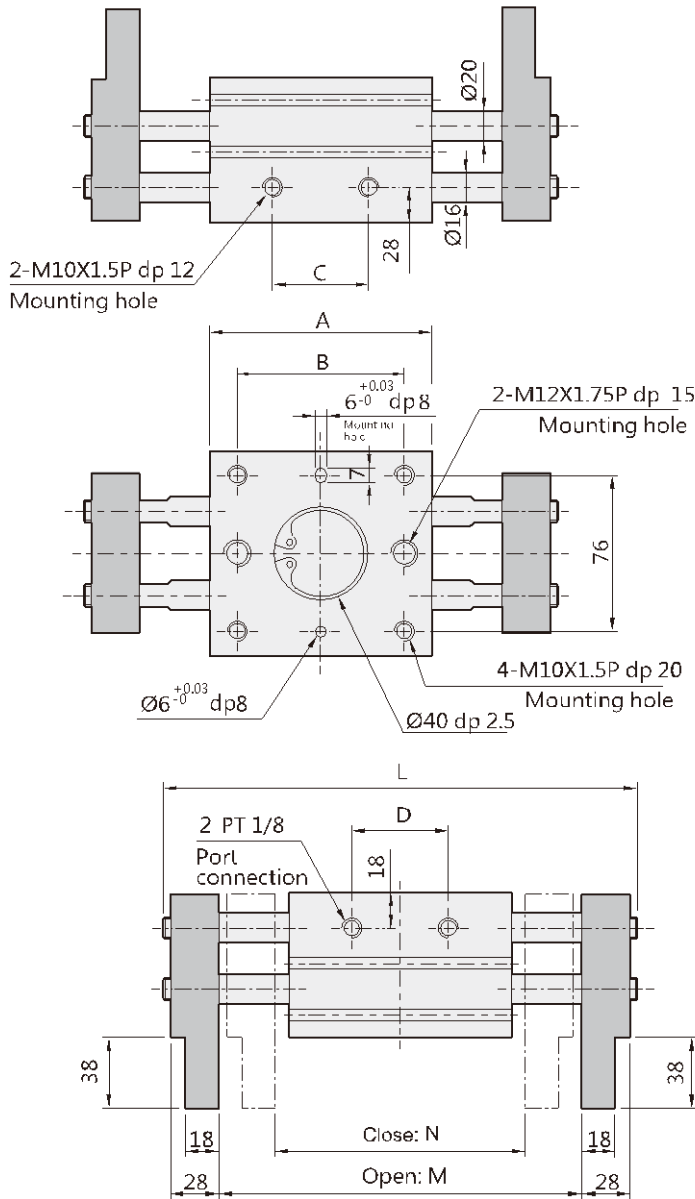

Unit: mm

Model	A	B	C	D	L	M	N
AHL 40100	148	116	80	80	324(224)	264	164
AHL 40160	206	174	138	138	442(282)	382	222
AHL 40200	246	214	178	178	522(322)	462	262