

AMH2-M series

2-Finger Heavy-load Type

Air Gripper/ with Dust Cover



Feature

- Wedge slider type
- Built-in magnet
- Large output and good stability

Specification

Item	Bore size (mm)	Ø25	Ø32	Ø40	Ø50
Action		Double acting			
Fluid		Air			
Pressure range	kgf / cm ² (kPa)	3 ~ 7 (300 ~ 700)			
Ambient and fluid temperature	°C	-5 ~ 60 (No freezing status)			
Max. operation frequency	time/min	80		60	
Lubrication		Non-lube			
Sensing device		With magnet			
Weight	kg	0.28	0.48	0.87	1.45

Code of order

AMH2-M^①25-AMS-L-2^②_③

①

Mark	Bore size (mm)
25	Ø25
32	Ø32
40	Ø40
50	Ø50

②

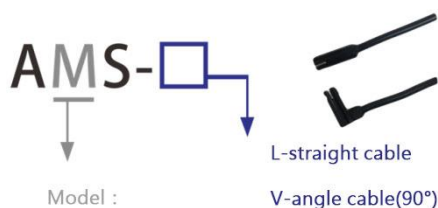

③

Mark	Sensor quantity
1	With 1 sensor switch
2	With 2 sensor switches

Operating type and data

Model	The smallest operating pressure (kgf/cm ²)	Thread port (mm)	Effective gripping force (N)	
			Open	Close
AMH2-M 20	3	4-M3x0.5Px4.5 dp	Open	94
			Close	84
AMH2-M 25	3	4-M4x0.7Px5 dp	Open	148
			Close	134
AMH2-M 32	3	4-M5x0.8Px8 dp	Open	245
			Close	221
AMH2-M 40	3	4-M6x1.0Px10 dp	Open	451
			Close	402
AMH2-M 50	3	4-M6x1.0Px10 dp	Open	738
			Close	662
AMH2-M 63	3	4-M8x1.25Px13 dp	Open	1245
			Close	1117
AMH2-M 80	3	4-M10x1.5Px10 dp	Open	1600
			Close	1500
AMH2-M 100	3	4-M12x1.75Px16 dp	Open	2300
			Close	2252

Note: The gripping force is the force of open and close gripper which in the length of gripping point is 30mm and acting pressure is 5kgf/cm².

Gripping force characteristic

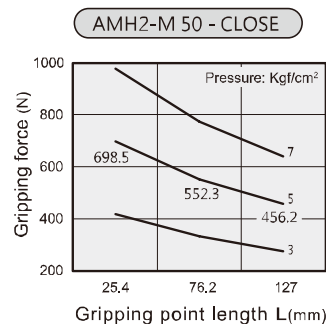
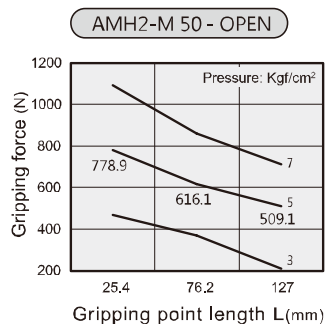
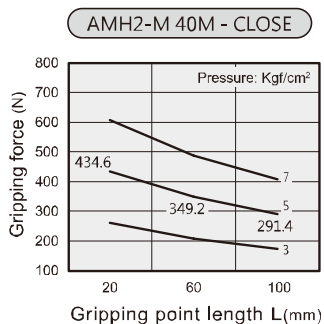
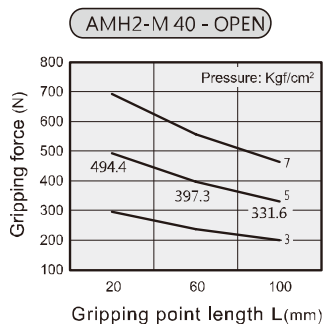
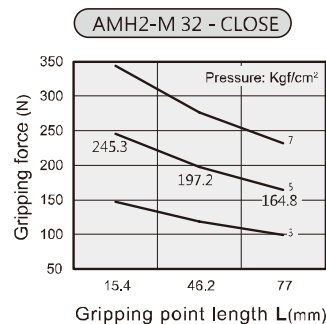
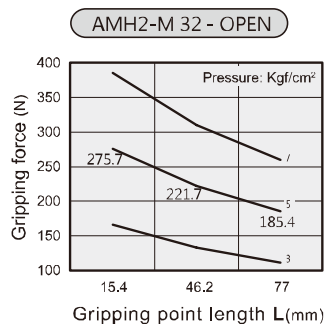
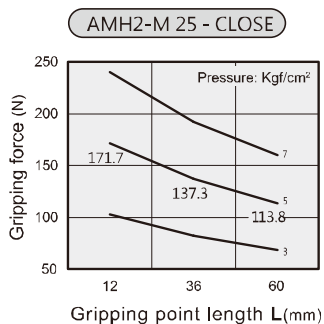
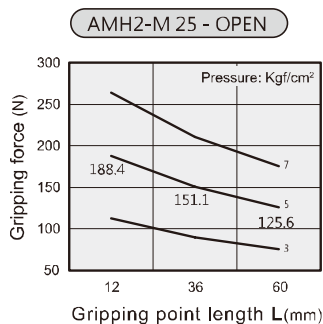
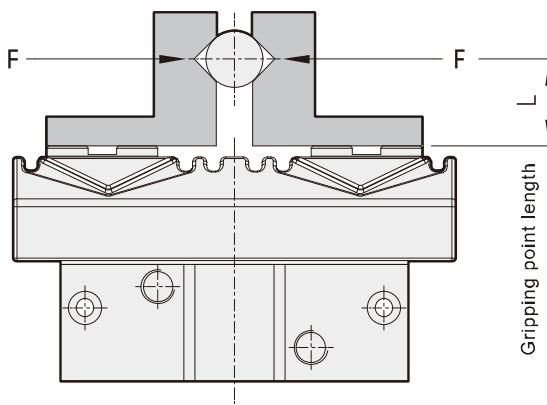

Dimensions

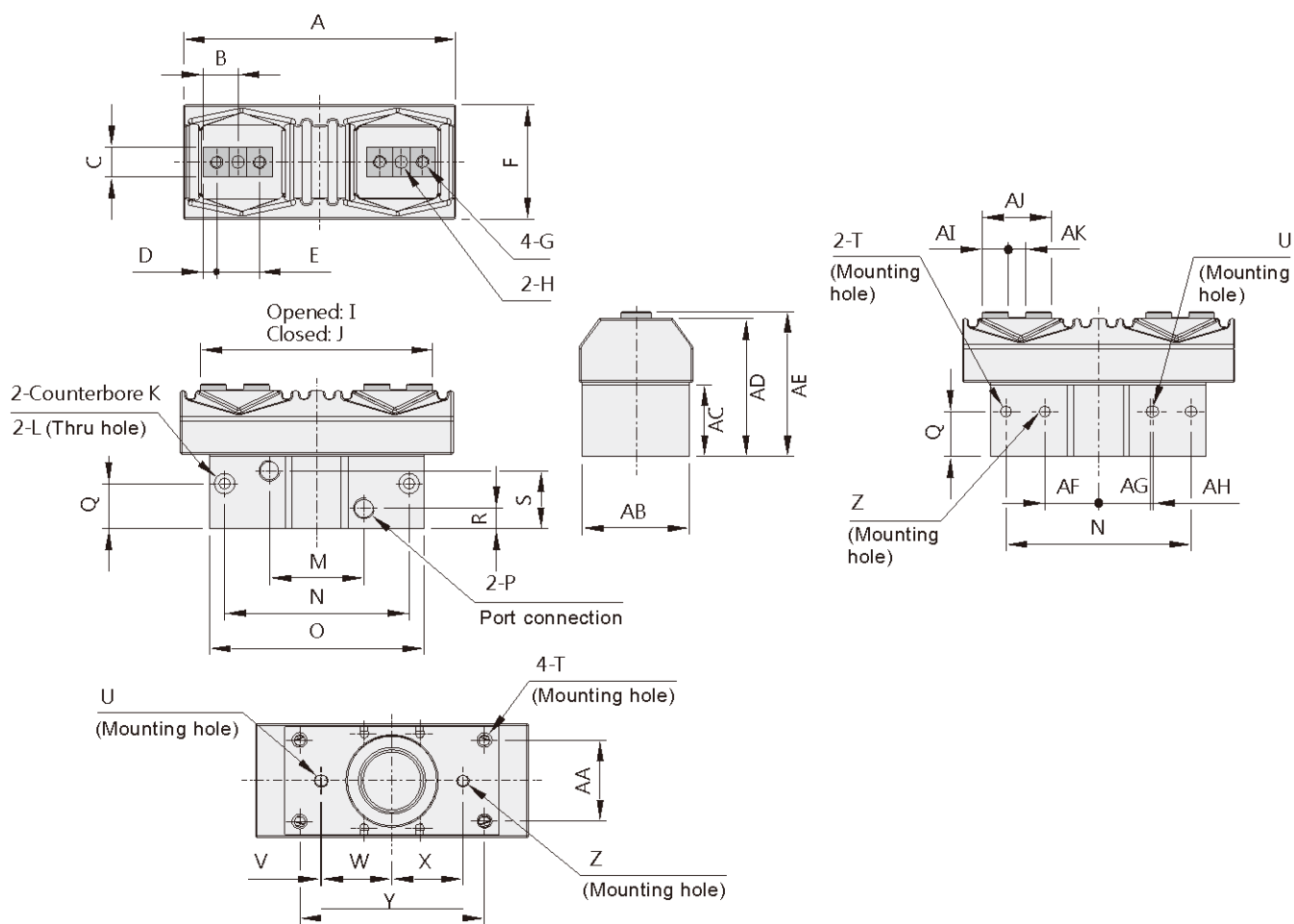

Unit: mm

Mark	A	B	C	D	E	F	G	H	I	J	K	L	M	N	O	P	Q	R	S	T	U	V	W
AMH2-M 2 5	83	10.5	10	4	13	39	M4x0.7Px5dp	Ø4	76	64	Ø8x8dp	Ø4.3	25.5	54	64	M5	17	8	22	M5	4x4.5dp	1	19.5
AMH2-M 3 2	103	13	12	5	16	45	M5x0.8Px8dp	Ø5	96	80	Ø8x8dp	Ø4.3	34	70	80	M5	20	9	26	M5	4x4.2dp	1	24.5
AMH2-M 4 0	127	16	14	6	20	53	M6x1.0Px10dp	Ø6	120	100	Ø9.5x9dp	Ø5.2	44	86	100	PT 1/8	21	9.5	27	M6	5x5.2dp	1	32.5
AMH2-M 5 0	160	20	16	8	24	63	M6x1.0Px10dp	Ø6	151	125	Ø11x12dp	Ø6.8	48	105	125	PT 1/8	24	11.5	33	M8	6x6.2dp	1	47.5

Unit: mm

Mark	X	Y	Z	AA	AB	AC	AD	AE	AF	AG	AH	AI	AJ	AK
AMH2-M 2 5	20	54	Ø4x4.5dp	27	36	25.6	48.2	50.6	14	13.5	1	8	21	5
AMH2-M 3 2	25	70	Ø4x4.2dp	32	42	29.2	55.7	59	18	17.5	1	10	26	6
AMH2-M 4 0	33	86	Ø5x5.2dp	38	50	33.5	64.3	67.5	25	24.5	1	12	32	8
AMH2-M 5 0	48	105	Ø6x6.2dp	44	60	41	74.7	79	30	29.5	1	16	40	8