



ATXC-30~80

Vacuum Pads Area Gripping



application

- Specially designed for IC boards, PCB boards, and panel handling.
- Suitable for material handling in any industry.
- EPDM (black) foamed chloroprene rubber

Order Code

ATXC-30x30V-10-E

① ② ③ ④ ⑤

①Model	②Size[mm]	③Valve technology	④Sponge Thickness[mm]	⑤Vacuum source
ATXC	30X30	None : None	5	E:External vacuum source
	30X50	V:Check valve	10	
	50X50			A:Built-in vacuum source
	50X80			
	80X80			

※For any other size requirements, please contact our sales representatives.

Model specifications

Model specifications	Valve technology		Vacuum source	
	V:Check valve	None	E:External vacuum source	A:Built-in vacuum source
30x30	●	●	●	
30x50	●	●	●	
50x50	●	●	●	
50x80	●	●	●	
80x80	●	●	●	●

Applications and Scope of Use

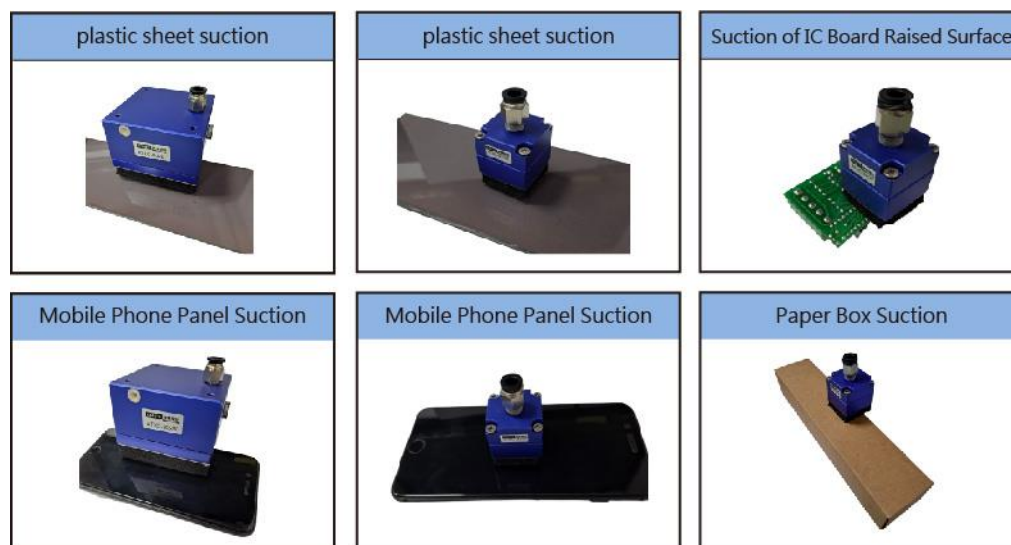

Dimensions

- ATXC-30X30-10-E(Without check valve / Without built-in generator)

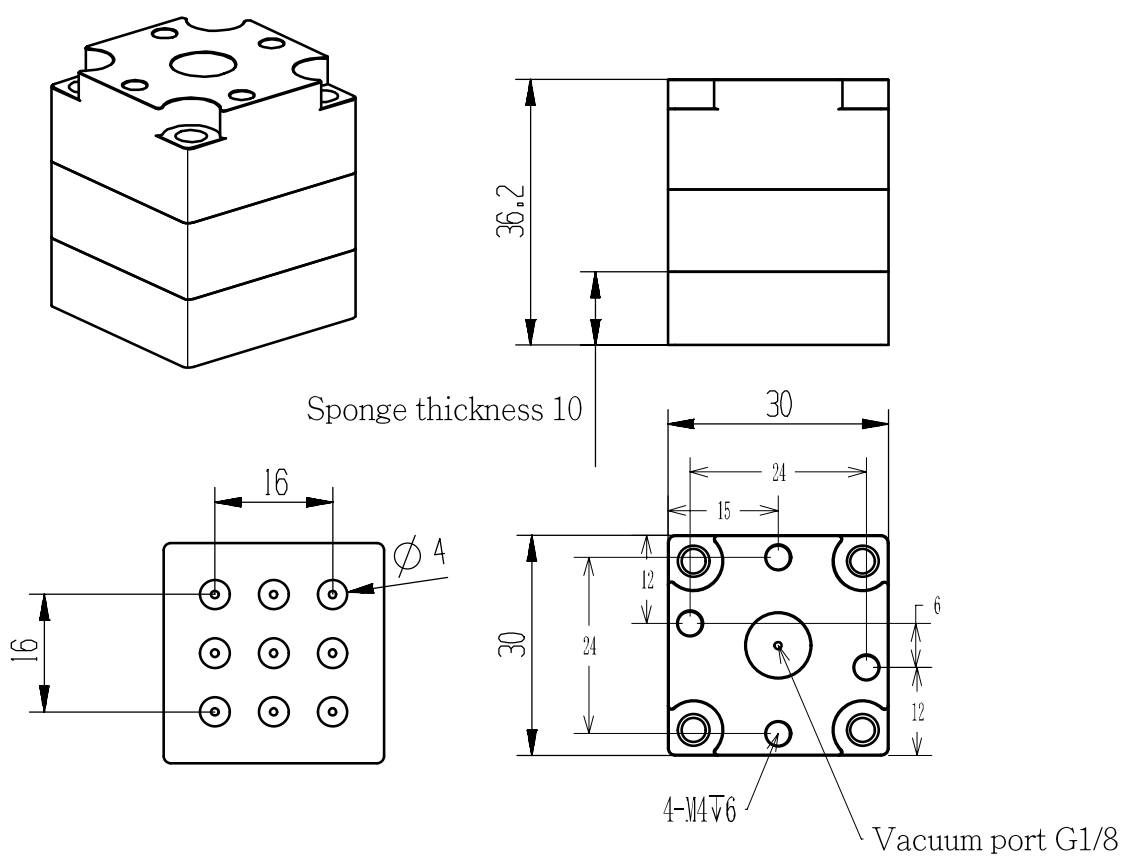

Vacuum Level (bar)	Theoretical Suction Force (kg)	Suction Cup Weight (kg)
0.5	0.5	0.15



■ ATXC-30X30V-10-E(With check valve / Without built-in generator)

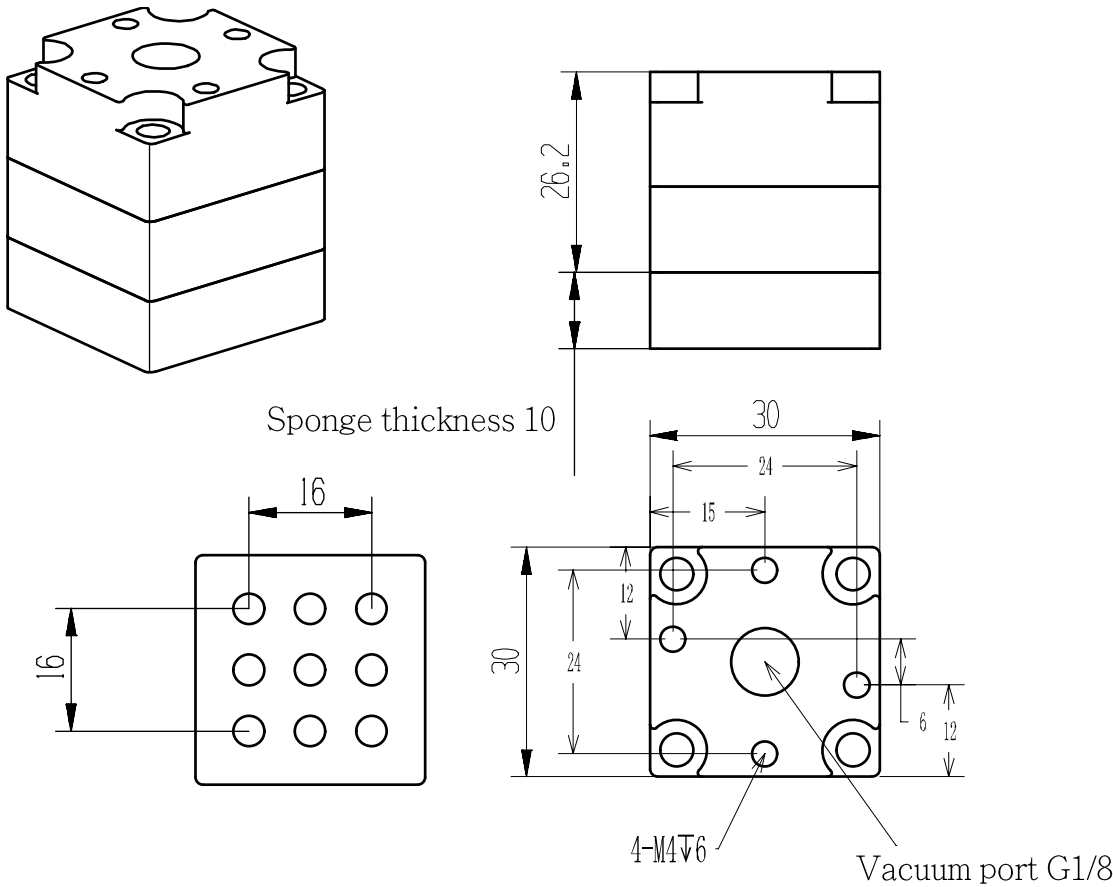

Vacuum Level (bar)	Theoretical Suction Force (kg)	Suction Cup Weight (kg)
0.5	0.5	0.15



■ ATXC-30X50-10-E(Without check valve / Without built-in generator)

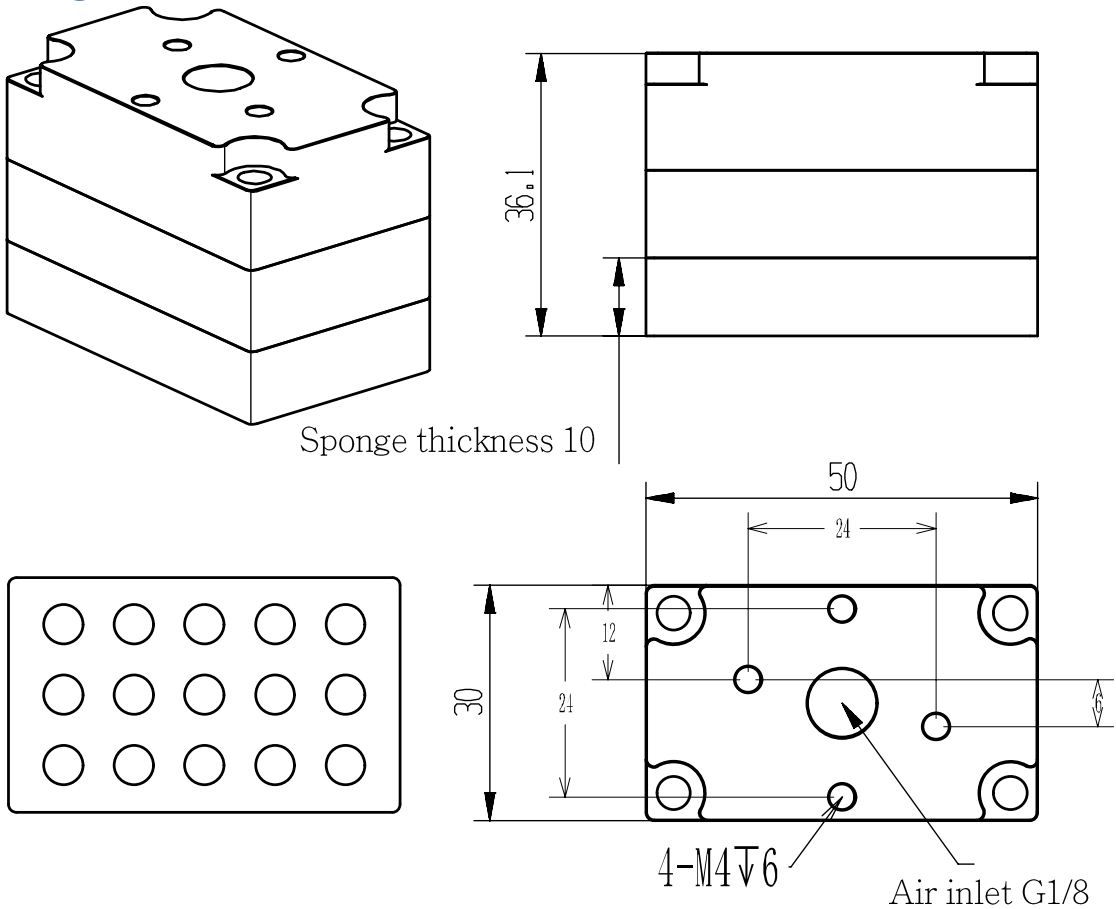

Vacuum Level (bar)	Theoretical Suction Force (kg)	Suction Cup Weight (kg)
0.5	1.47	0.2



■ ATXC-30X50V-10-E(With check valve / Without built-in generator)

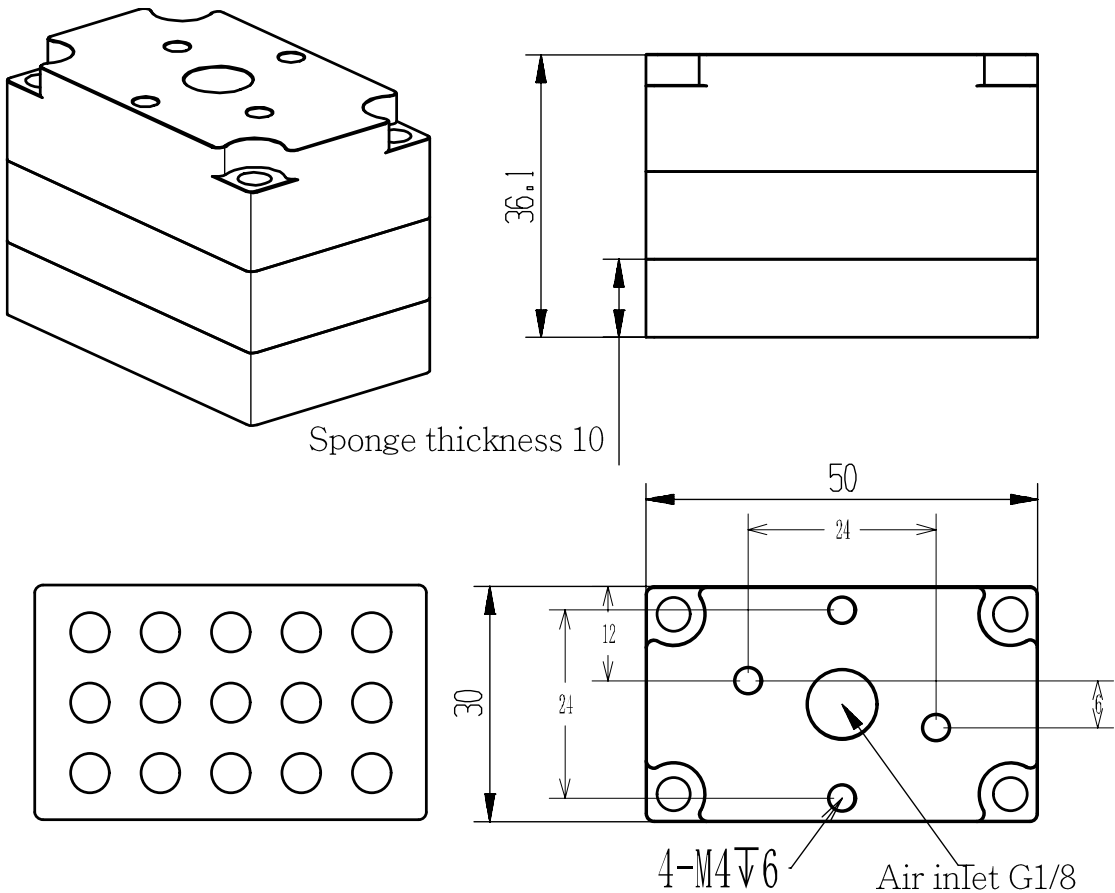

Vacuum Level (bar)	Theoretical Suction Force (kg)	Suction Cup Weight (kg)
0.5	1.47	0.2



■ ATXC-50X50-10-E(Without check valve / Without built-in generator)

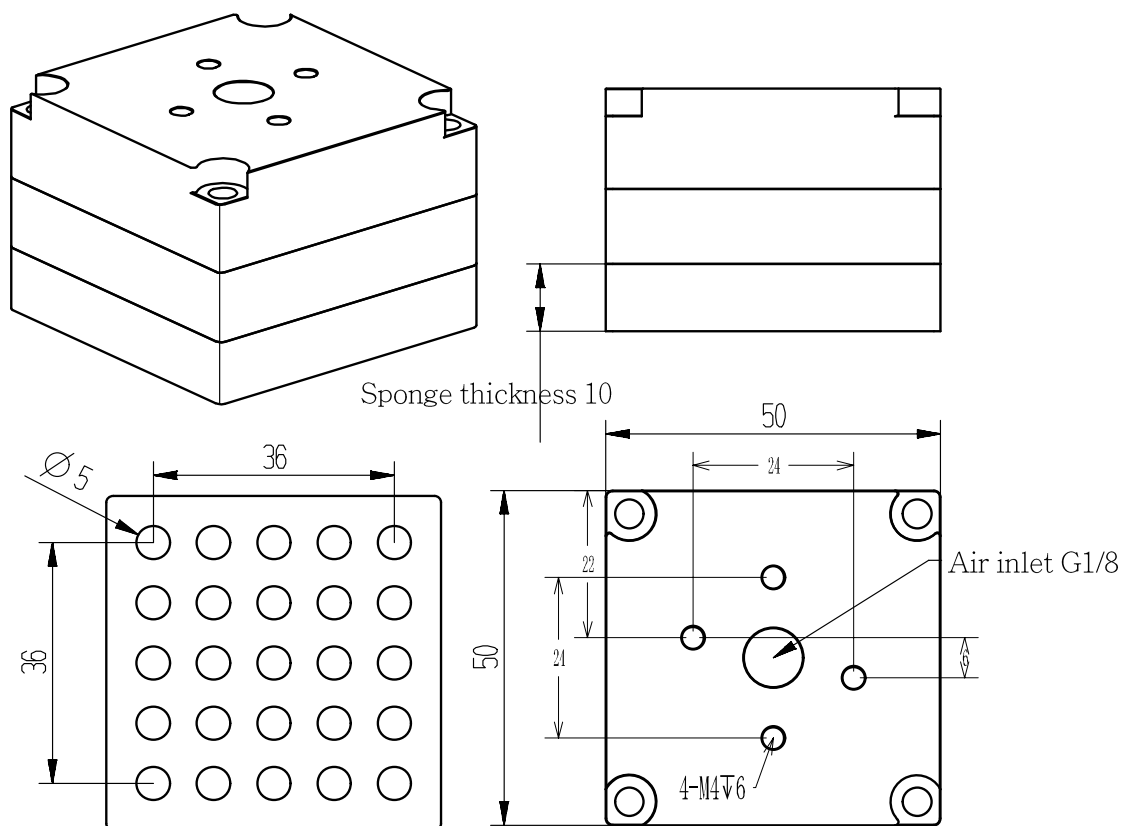

Vacuum Level (bar)	Theoretical Suction Force (kg)	Suction Cup Weight (kg)
0.5	2.45	0.2



■ ATXC-50X50V-10-E(With check valve / Without built-in generator)

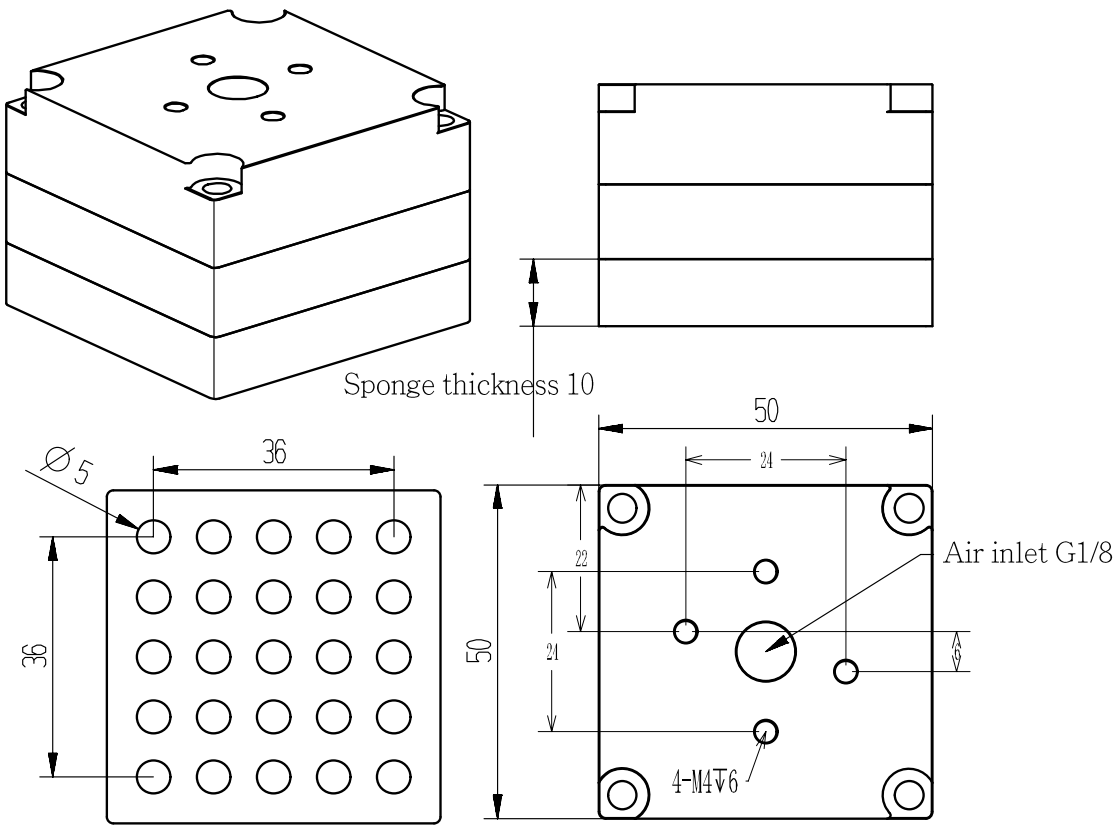

Vacuum Level (bar)	Theoretical Suction Force (kg)	Suction Cup Weight (kg)
0.5	2.45	0.2



■ ATXC-50X80-10-E(Without check valve / Without built-in generator)

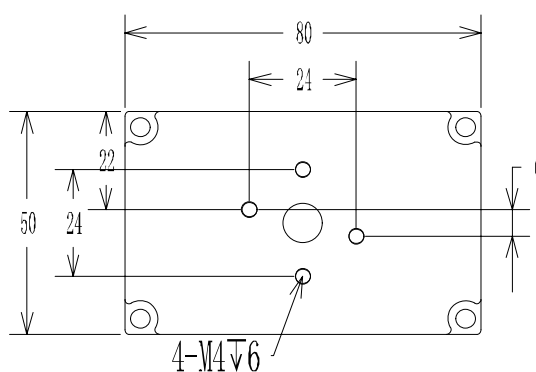
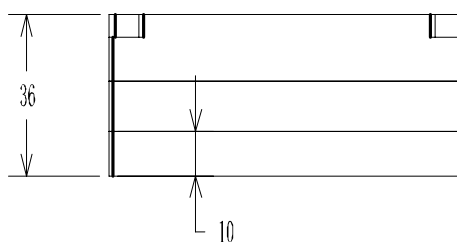
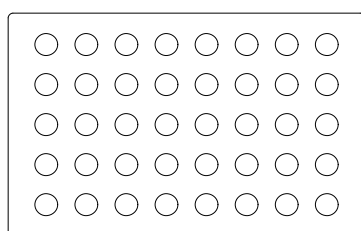
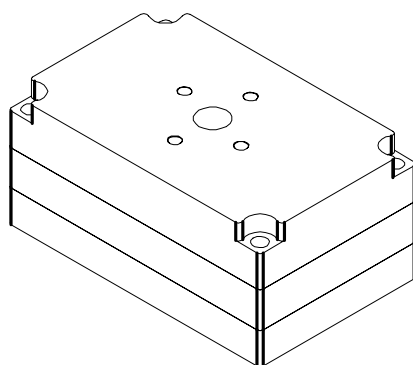

Vacuum Level (bar)	Theoretical Suction Force (kg)	Suction Cup Weight (kg)
0.5	3.9	0.7



■ ATXC-50X80V-10-E(With check valve / Without built-in generator)

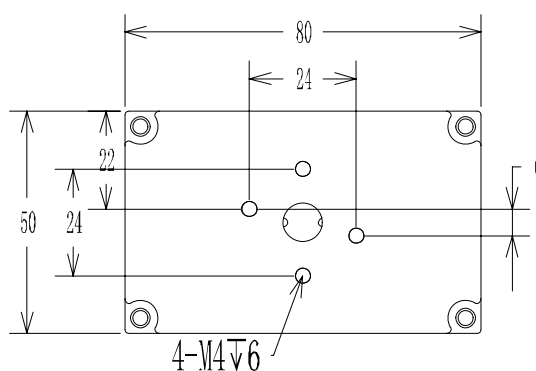
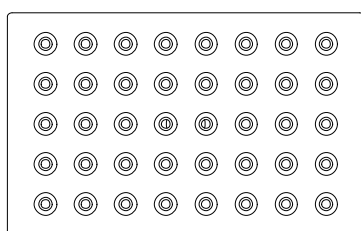
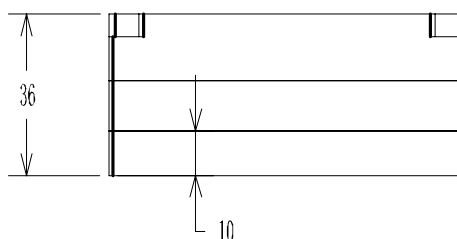
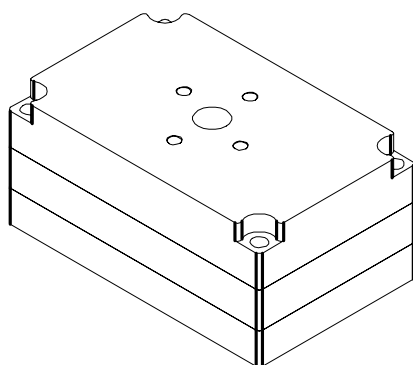

Vacuum Level (bar)	Theoretical Suction Force (kg)	Suction Cup Weight (kg)
0.5	3.9	0.7



■ ATXC-80X80V-10-A (With check valve / built-in generator)

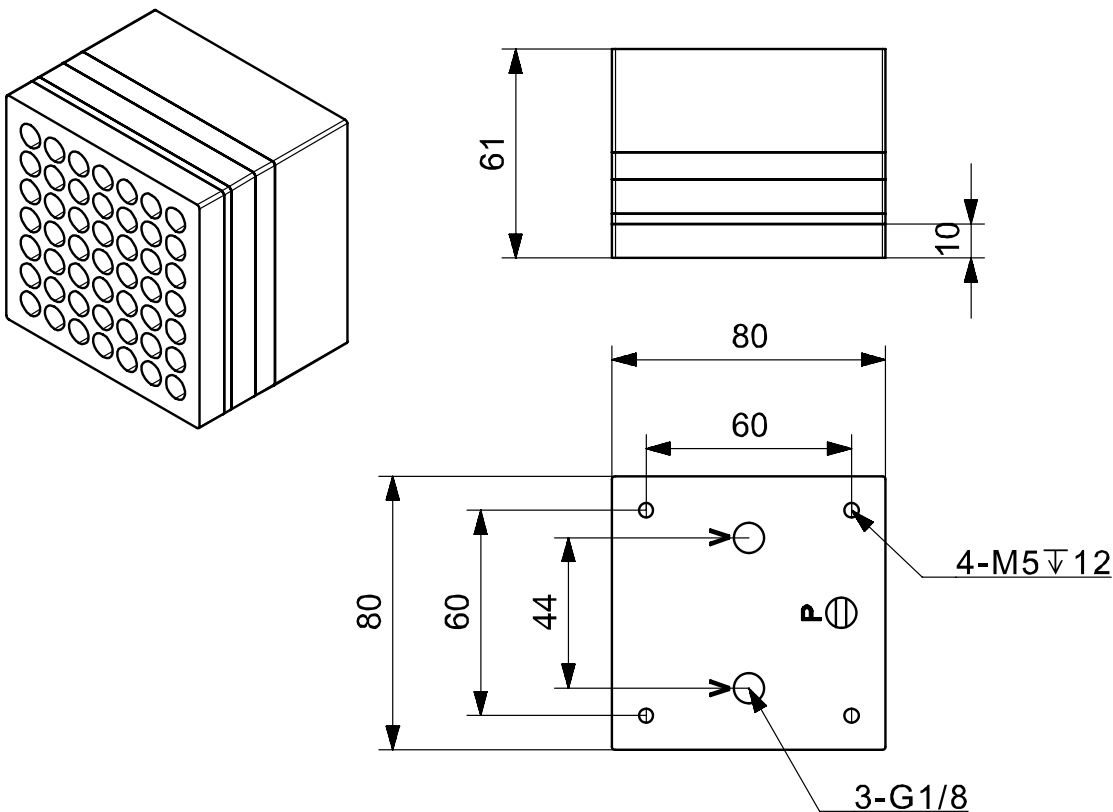

Vacuum Level (bar)	Theoretical Suction Force (kg)	Suction Cup Weight (kg)
0.5	12.3	0.35



■ ATXC-80X80V-10-E (With check valve / without built-in generator)

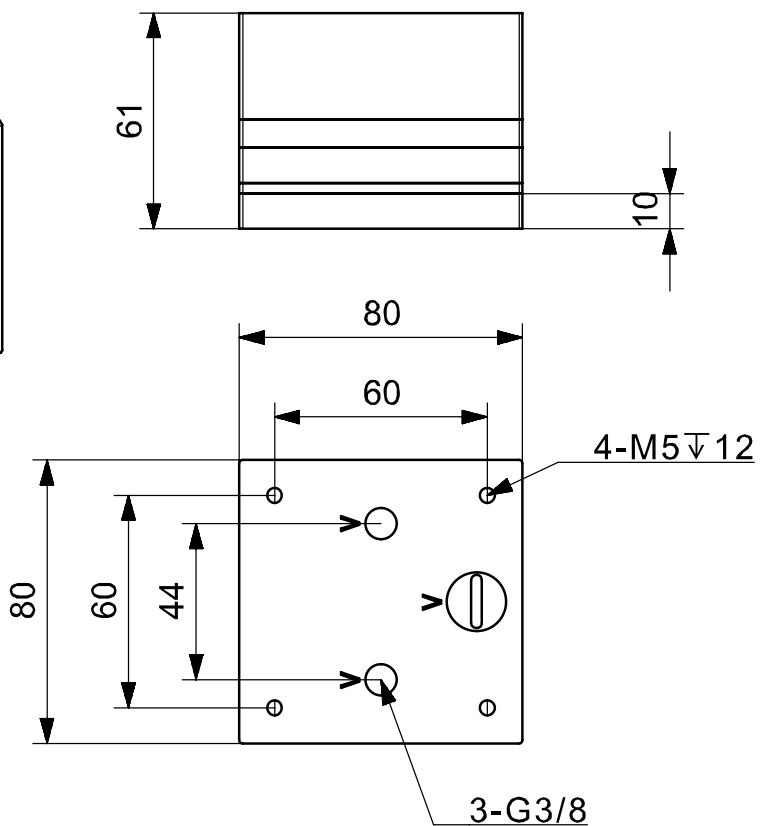
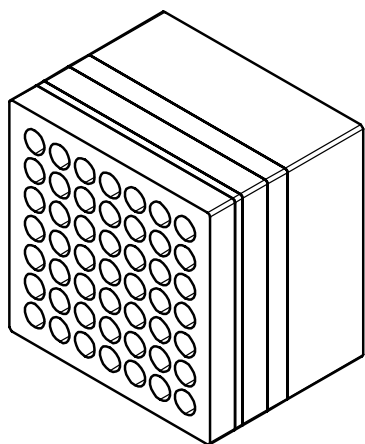

Vacuum Level (bar)	Theoretical Suction Force (kg)	Suction Cup Weight (kg)
0.5	12.3	0.35