

KS2

Integrated Vacuum Generator



Product Features

- Designed for handling airtight or slightly porous workpieces in the electronics, electrical engineering, packaging technology, robotics, and automotive industries.
- RD is an energy-saving vacuum switch; energy-saving vacuum generator that reduces air consumption by 90% compared to non-energy-saving models. Equipped with an energy-saving function vacuum digital pressure switch that stops air supply once the set vacuum value is reached.
- Integrated DIN rail mounting and centralized air intake.

Order Code

KS2 10 H S NC AS VD NPN B 2
 ① ② ③ ④ ⑤ ⑥ ⑦ ⑧ ⑨ ⑩

① Model	② nozzle size	③ maximum vacuum pressure	④ rated supply pressure	⑤ initial state of the intake valve
KS2	10 - 1.0mm 15 - 1.5mm XI10 - 0.8mm PI12 - 0.9mm	H - -85 Kpa	S - 0.5 Mpa R - 0.35 Mpa	NC - normally closed NO - normally open

⑥ blow-off valve and safety valve	⑦ system monitoring	⑧ switching output mode	⑨ mute selection	⑩ product quantity
AS - blow-off valve and safety check valve	blank- without vacuum switch VD - digital vacuum switch RD - energy-saving vacuum switch	NPN PNP	blank- standard mute B - high mute	blank - 1 unit 2 - 2 unit 3 - 3 unit 4 - 4 unit 5 - 5 unit 6 - 6 unit 7 - 7 unit 8 - 8 unit

Note: XI10 can only correspond to HS, PI12 can only correspond to HR;

⑦ is blank and does not require selection ⑧;

⑩ is blank and does not require selection ⑩;

performance parameters

Model	nozzle size [mm]	vacuum level [%]	maximum suction capacity [l/min]	air consumption rate [l/min]	working pressure [bar]	operating temperature [°C]	weight [g]
KS2 10 HS ...	1.0	85	27	44	5	0 ... 45	130
KS2 10 HR ...	1.0	85	25	44	3.5	0 ... 45	130
KS2 15 HS ...	1.5	85	63	100	5	0 ... 45	130
KS2 15 HR ...	1.5	85	54	100	3.5	0 ... 45	130
KS2 XI10 HS...	0.8	85	45	28	5	0 ... 45	130
KS2 PI12 HR...	0.9	85	41	32	3.5	0 ... 45	130

performance curve

Vacuum flow rates corresponding to different levels of vacuum at 5 bar operating pressure

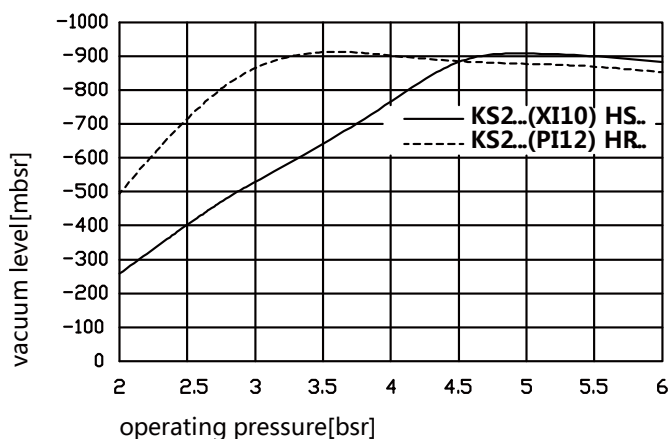

Vacuum flow rates corresponding to different levels of vacuum at a 5-bar operating pressure

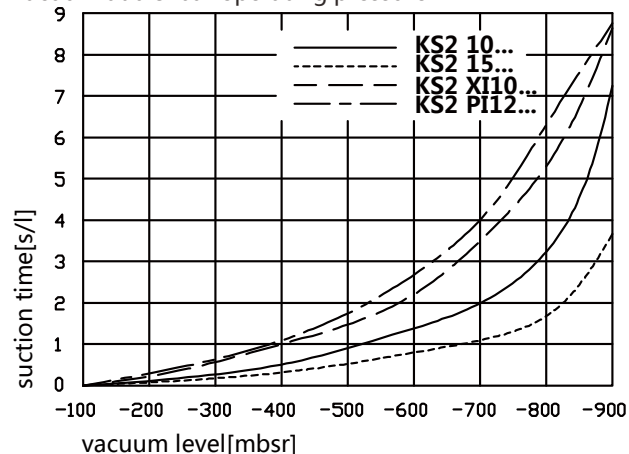

Vacuum flow rates corresponding to different levels of vacuum at a 5-bar operating pressure

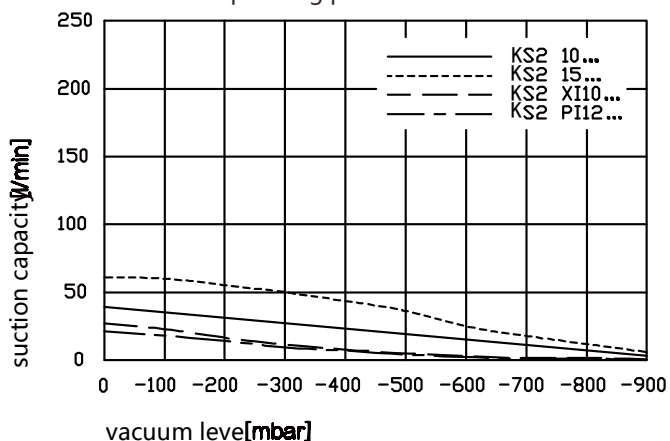



performance parameters

Model	Size [mm]		d1	d2	H	L	L1	L2	X	Y
	B	D								
KS2...NC/NO...	15	4.3	6	6	87	92.3	83	80	49	12
KS2...NC/NO...VD/RD	15	4.3	6	6	87	114.3	105	80	49	12

Dimensions

KS2...NC...

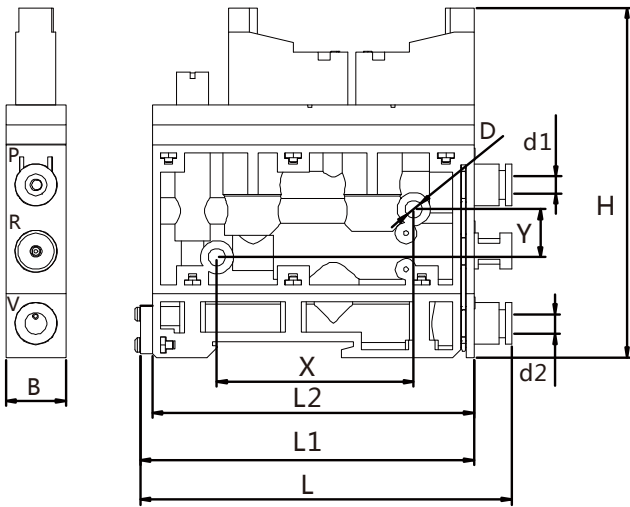

KS2...NO...

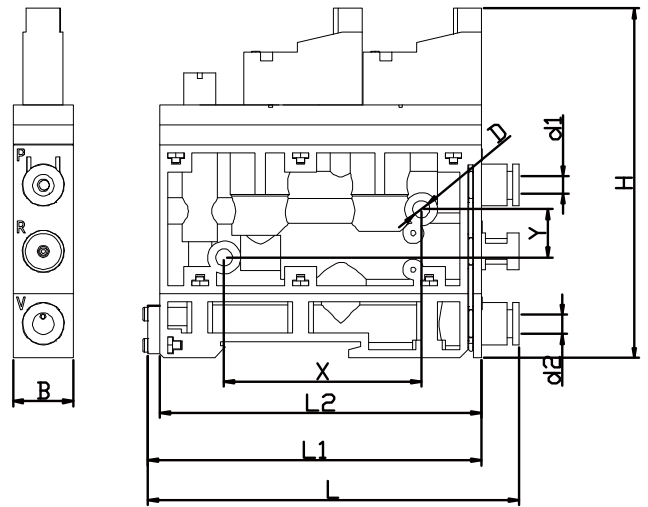

KS2...NC...VD/RD

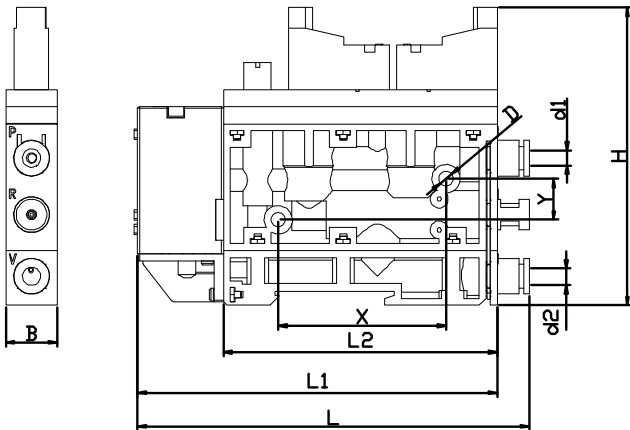

KS2...NO...VD/RD

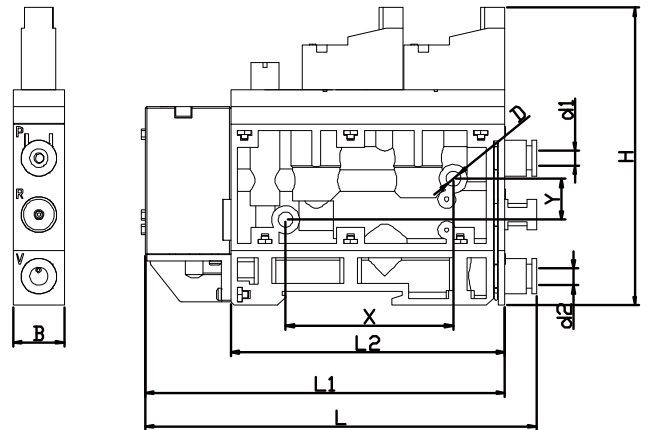

performance parameters

name	component model number	note
Sound-absorbing cotton	KS2-XYM	—
High-performance muffler or silencer	KS2-GXYXYQ	—
Electromagnetic valve terminal wire	KS2-N	Plug lead wire 300mm

Order Code

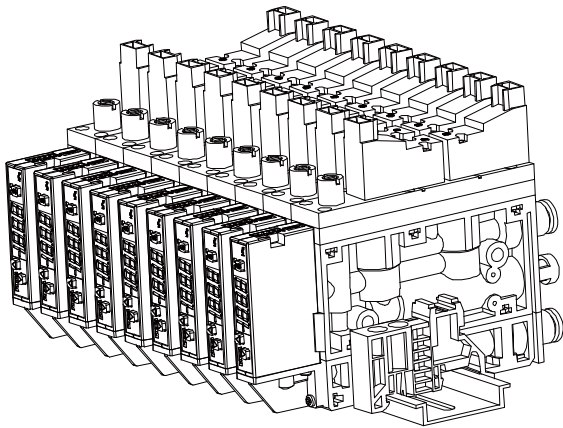

containerized standalone air intake

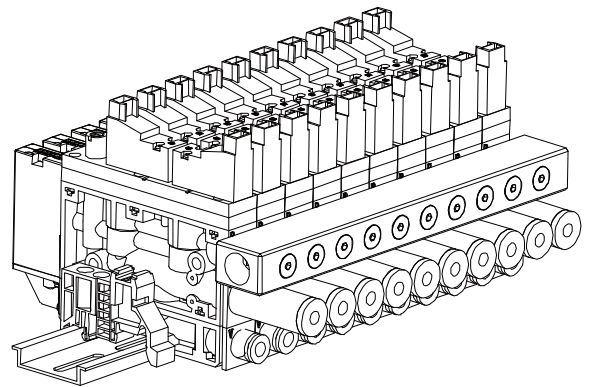

containerized standalone air intake

Order Code

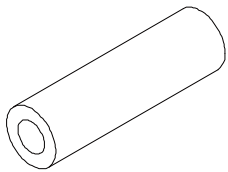

Sound-absorbing material (standard soundproof type)

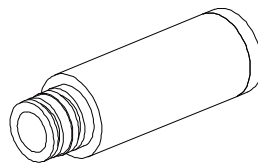

sound muffler (silencer)

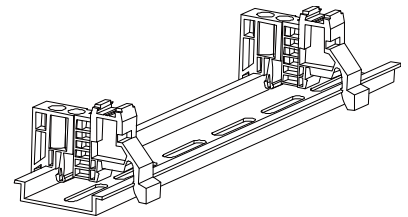

guide rail diagram