

## MPE vacuum round sponge suction cup

Size:40-180mm

Material:E



Packaging



Stone



Rough surface



### Introduction

- Round foam sponge · Metal holding plate
- EPDM foam (black)
- Long service life, good sealing, strong suction force
- Light weight, heavy-load, large-area holding plate
- The customer can choose the appropriate model according to the actual operating condition
- Applicable to workpieces of different sizes and in different shapes

### Application

- Applicable to suctioning objects with very rough or uneven surfaces, such as rough slates, embossed plates, marble slabs, tiles, cement slabs, checkered metal plates, etc.
- EPDM-With high resistance to weather and ozonation but poor yielding and storage stability, applicable to gripping objects with rough surfaces, suitable for outdoor operations, but not suitable for applications in the food industry

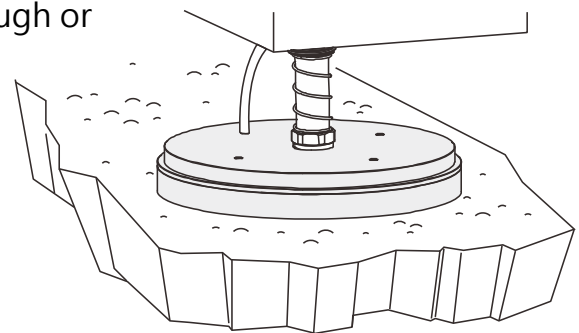

### Structure

- Consists of a metal holding plate and sponge, where the sponge is self-adhesive and can be directly stuck to the holding plate, and can be purchased and replaced separately

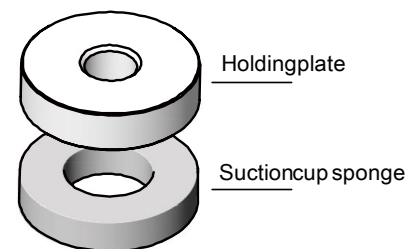

purchase guide

**MPE 40 G1/4-IG E**

① ② ③ ④

| ① Product series | ② Suction area  | ③ Connecting thread  | ④ Material |
|------------------|---|--|------------|
| MPE              | 40 - φ 40mm<br>64 - φ 64mm<br>92 - φ 92mm<br>127 - φ 127mm<br>180 - φ 180mm | G1/4-IG - G1/4 female thread<br>G3/8-IG - G3/8 female thread<br>Note:IG=Femalethread | E - EPDM   |

Model specifications

| Model specification | G1/4-IG | G3/8-IG |
|---------------------|---------|---------|
| MPE 40...           | ●       | -       |
| MPE 64...           | ●       | -       |
| MPE 92...           | -       | ●       |
| MPE 127...          | -       | ●       |
| MPE 180...          | -       | ●       |

Model specifications of fittings

| Fitting Name       | Material   | Applicable Suction Cup |
|--------------------|------------|------------------------|
|                    | EPDM       |                        |
| Suction cup sponge | MPE ED 40  | MPE 40                 |
|                    | MPE ED 64  | MPE 64                 |
|                    | MPE ED 92  | MPE 92                 |
|                    | MPE ED 127 | MPE 127                |
|                    | MPE ED 180 | MPE 180                |

Technical parameters

| Model          | Suction force<br>N | Internal Volume<br>cm <sup>3</sup> | Operating temperature<br>°C | Weight<br>g |
|----------------|--------------------|------------------------------------|-----------------------------|-------------|
| MPE 40 G1/4 □  | 7.8                | 4.7                                | -40...80                    | 35.6        |
| MPE 64 G1/4 □  | 35                 | 18.8                               | -40...80                    | 86.5        |
| MPE 92 G3/8 □  | 85                 | 48.2                               | -40...80                    | 196.3       |
| MPE 127 G3/8 □ | 175                | 99.6                               | -40...80                    | 490         |
| MPE 180 G3/8 □ | 385                | 230.7                              | -40...80                    | 780         |

Design parameters

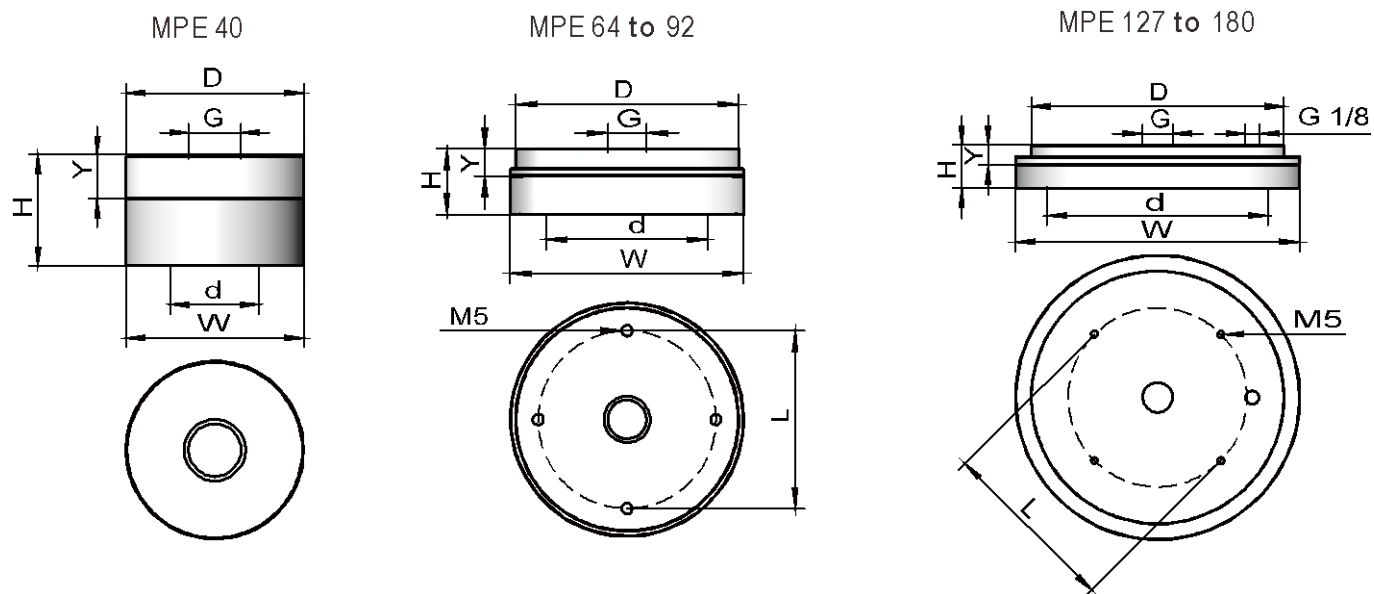

| Model          | Size (mm) |     |    |    |     |     |      |  |  |
|----------------|-----------|-----|----|----|-----|-----|------|--|--|
|                | D         | d   | H  | Y  | W   | L   | G    |  |  |
| MPE 40 G1/4 □  | 40        | 20  | 25 | 10 | 40  | -   | G1/4 |  |  |
| MPE 64 G1/4 □  | 60        | 40  | 25 | 10 | 64  | 50  | G1/4 |  |  |
| MPE 92 G3/8 □  | 88        | 64  | 26 | 11 | 92  | 70  | G3/8 |  |  |
| MPE 127 G3/8 □ | 120       | 92  | 30 | 15 | 127 | 100 | G3/8 |  |  |
| MPE 180 G3/8 □ | 160       | 140 | 27 | 12 | 180 | 115 | G3/8 |  |  |